

UPPER WALL FRAME LAYOUT

CEILING HEIGHT - 2700mm

STRUCTURAL DETAILS

T & B PLATES 90x35 MGP10 UNO
EXTERNAL STUDS 90x35 MGP10 @ 600 CTS UNO
STUDS POSITIONED DIRECTLY BENEATH RAFTER/TRUSSES
@ MAX 600MM CTS

ROOF COVERING :
ROOF PITCH :
CEILING HEIGHT :
OVERHANG :

C/BOND
25 deg
2700 mm
450 mm

INTERNAL STUDS 90x35 MGP10 @ 600 CTS UNO
STRUTS BLOCKED OVER 2 SINGLE 90x45 MGP10 STUDS
BLOCKING 90x70 MGP10

NOGGING 90x35 PINE @ 1350 MAX CTS
1/90x35 MGP10 DIRECTLY BENEATH INTERNAL SUPPORT
ALL STRUCTURAL MATERIAL TO BE MGP10, UNO.

JOINT GROUP=JD5

ALL MATERIALS ALLOWED AS PER AS 1684.2-2010
NON-LOAD BEARING WALLS UNDER
TRUSSES SET DOWN 20mm

STUDS AT SIDES OF OPENINGS
AND POINT LOAD STUDS
AS SHOWN BELOW

△ = 1/90x45 MGP10
X = 2/90x35 MGP10
□ = 2/90x45 MGP10

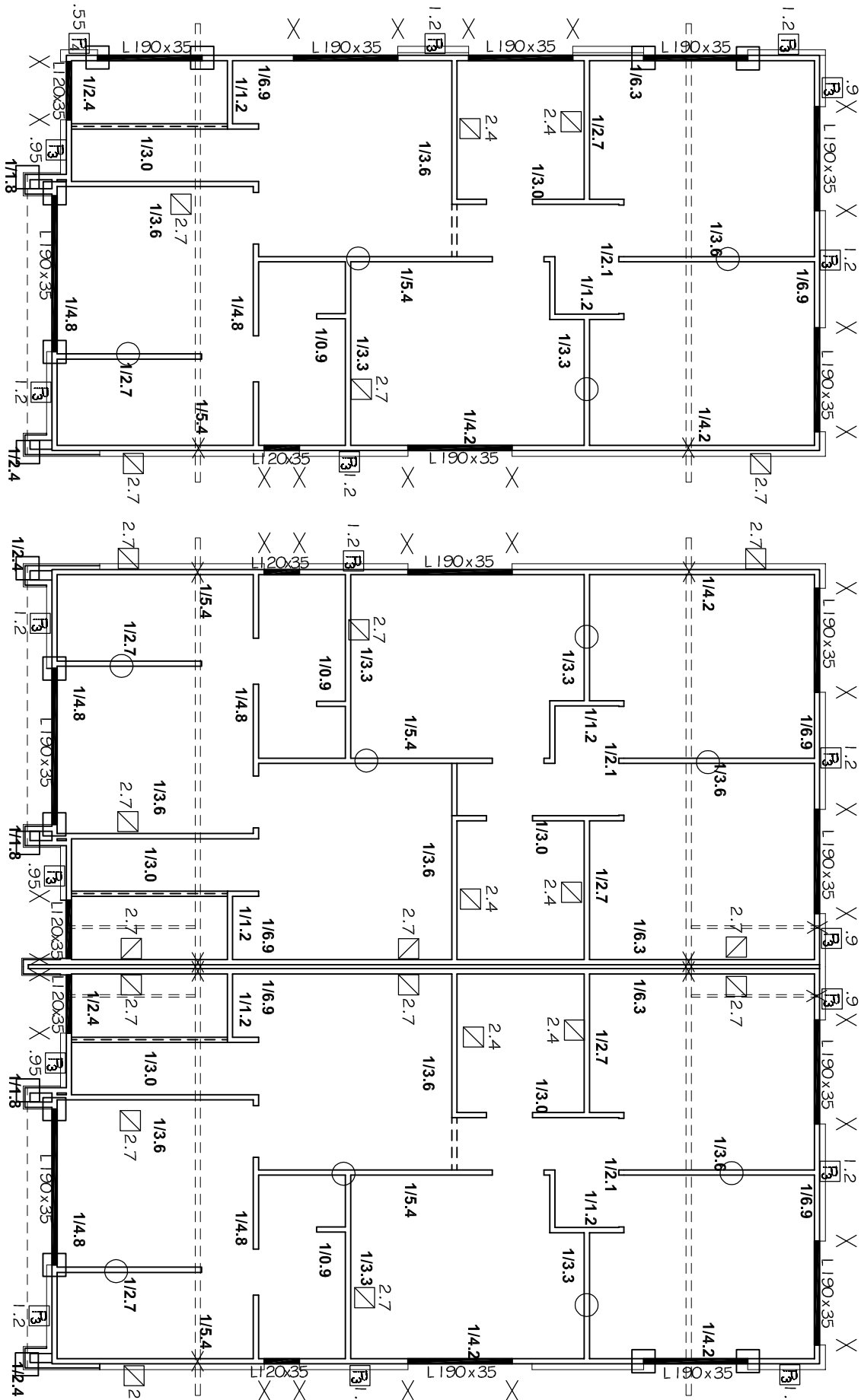

D3

D2

D1

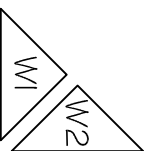

TOP PLATE FIXING DETAILS - PARALLEL TO WALL

- TABLE B.22 (C)

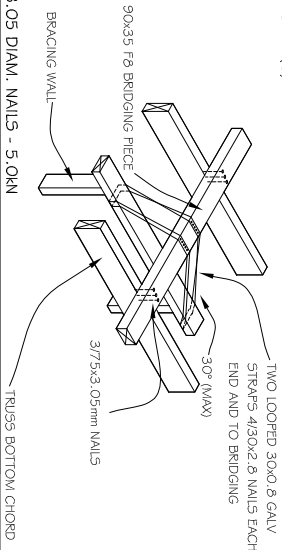

* 6/3.05 DIAM. NAILS - 5.0kN

TOP PLATE FIXING DETAILS - PERP. TO WALL

- TABLE B.22 (I)



INTERNAL WALL BRACKET NAILED AT TOP OF SLOOT. DO NOT DRIVE HOME TO ALLOW FOR VERTICAL MOVEMENT OF TRUSSES

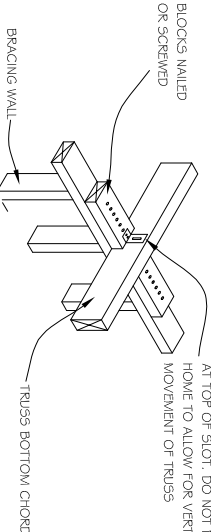

BRACING WALL

TRUSSES BOTTOM CHORD

* 6/3.05 DIAM. NAILS - 5.0kN

* 3/IN. 1.4 TYPE 17 SCREWS - 1.0kN

BRACING UNITS

METAL ANGLE BRACE

- TABLE B.18 (C)

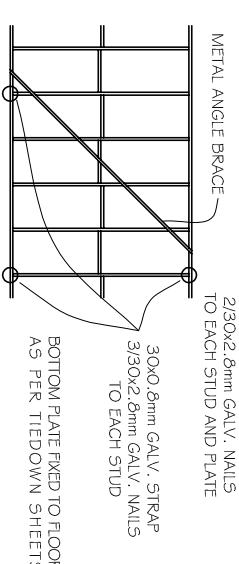

BOTTOM PLATE FIXED TO FLOOR AS PER TIEDOWN SHEETS

□ - 1800mm (2.7kN)

□ - 2100mm (3.15kN)

□ - 2400mm (3.6kN)

□ - 2700mm (4.05kN)

OS BRACE TYPE #3 | SYSTEM 6.0kN/m

OR EQUIVALENT

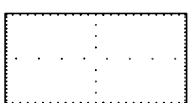

- FASTENER SPACING
 - 40mm TOP & BOTTOM PLATES
 - 150mm VERTICAL EDGES
 - 300mm INTERMEDIATE STUDS
- MINIMUM SECTION OF BRACING OF 900mm
- 2mm DRAGON GAP AROUND PERIMETER OF EVERY PANEL
- 2.8x30mm FLAT HEAD GALVANISED OR CORROSION RESISTANT NAILS, OR THEIR GUN DRIVEN EQUIVALENT, MINIMUM OF 15mm FROM EDGE OR 8mm WHERE PANELS ARE FIXED TO INTERNAL FRAMING

□ - 900mm (5.4kN)

□ - 1200mm (7.2kN)

OS BRACE TYPE #4 | SHORT WALL BRACING | SYSTEM 2.2kN/m

OR EQUIVALENT

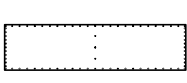

- FASTENER SPACING
 - 80mm TOP & BOTTOM PLATES
 - 150mm VERTICAL EDGES
 - 1010 x 70mm COACH SCREWS WITH 50x50x3mm WASHERS IN EACH CORNER OF EACH SHEATHED SHORT WALL SECTION
- MINIMUM SECTION OF BRACING OF 450mm
- 2mm DRAGON GAP AROUND PERIMETER OF EVERY PANEL
- 2.8x30mm FLAT HEAD GALVANISED OR CORROSION RESISTANT NAILS, OR THEIR GUN DRIVEN EQUIVALENT, MINIMUM OF 15mm FROM EDGE OR 8mm WHERE PANELS ARE FIXED TO INTERNAL FRAMING

□ - 450mm (1.0kN)

□ - 600mm (1.3kN)

ADDITIONAL ANGLE BRACE

WINDSPEED (per residence) :

W1 16 m² = 9 kN

W2 36 m² = 20 kN

S:\OAKRIDGE TAKEOFFS\D\ANDREA\50-52 WINDSOR ST\DWLG 1-3\DWLG 1-3 50 WINDSOR ST.dwg

DANDREA

WP PROPERTY GROUP
50-52 WINDSOR ST, MAGILL

Detailer: Matt Opie

Signed:

AMENDMENTS

FRAMING AMENDED 14/02/2019

SHEET 3/5

DATE : 07/12/18

SCALE: 1 : 100

JOB No. T102360112

OAKRIDGE
BUILDING SERVICES

PH : 83837222

FAX : 83837225